



8, Latchmere Lodge Bulford Road, Durrington, SP4 8DQ

£825 PCM

About The Property

This one-bedroom flat is located in the centre of Durrington. Upon entering, you will find an entrance hallway that leads to the bedroom, which features a large double-glazed window, a built-in wardrobe, storage space, and electric heating.

Continuing down the hallway, you will find the bathroom, which has recently been repainted. It includes an electric shower over the bath and benefits from a sizable storage cupboard that houses an insulated hot water cylinder, along with ample space for linen and towels.

At the far end of the flat is a well-proportioned kitchen/diner/lounge area, complete with wood-effect vinyl flooring. The modern kitchen is equipped with a ceramic electric hob, an electric fan oven, and space for an undercounter fridge/freezer, as well as a washing machine.

The flat is available for long-term rental and is offered unfurnished

- One bedroom flat
- Modern kitchen
- Recently redecorated
- Allocated parking
- Electric heating
- Unfurnished
- Long term tenancy
- EPC C



484.00 sq ft





Ground Floor

Approx. 45.0 sq. metres (484.2 sq. feet)

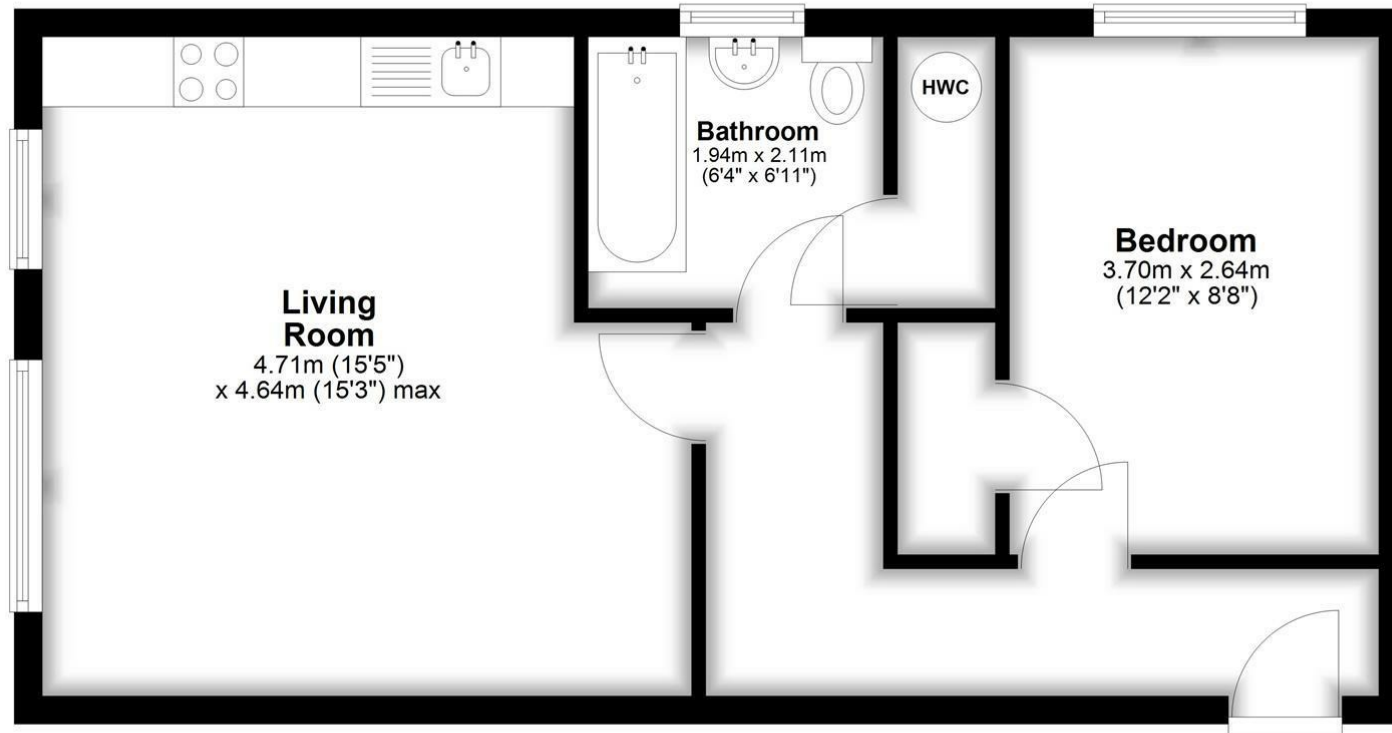

Living Room
4.71m (15'5")
x 4.64m (15'3") max

Bathroom
1.94m x 2.11m
(6'4" x 6'11")

Bedroom
3.70m x 2.64m
(12'2" x 8'8")

Total area: approx. 45.0 sq. metres (484.2 sq. feet)

Further Information

Let available date: 17th April 2026
NB: This date is provisional and will only be confirmed once referencing has been successfully completed.

Property type: Flat

Furnish type: Unfurnished

Deposit: £950

Local authority: Wiltshire

Council Tax: Band B

EPC: C(71)

Energy Efficiency Rating

| | Current | Potential |
|---|----------------------------|-----------|
| Very energy efficient - lower running costs | | |
| (92 plus) A | | |
| (81-91) B | | 84 |
| (69-80) C | 71 | |
| (55-68) D | | |
| (39-54) E | | |
| (21-38) F | | |
| (1-20) G | | |
| Not energy efficient - higher running costs | | |
| England & Wales | EU Directive 2002/91/EC | |